

FEATURES

- Solenoid valves satisfy all relevant EC directives
- All products are covered by the Pressure Equipment Directive 97/23/EC and are suitable for group 1 and 2 fluids
- Two way shut-off valves for automatic control of air, inert gas, water, light oil and other gases/liquids compatible with the sealing materials used
- Valves require a minimum ΔP of 0,35 bar

GENERAL

Differential pressure 0,35 - 17 bar [1 bar = 100 kPa]
Maximum viscosity 65 cSt (mm²/s)
Response times 15 - 120 ms

fluids (*)	temperature range (TS)	sealings (*)
air, inert gas, water, oil	-20 to +85°C	NBR (nitrile / buna-n)

MATERIALS IN CONTACT WITH FLUID

(*) Ensure that the compatibility of the fluids in contact with the materials is verified

Body Brass
Core tube Stainless steel
Core and plugnut Stainless steel
Springs Stainless steel
Seat Brass
Sealing, diaphragm & disc NBR
Piston Stainless steel
Disc holder PA (nylon)
Shading coil Copper

ELECTRICAL CHARACTERISTICS

Coil insulation class F
Connector Spade plug (Pg 11P)
Connector specification ISO 4400
Electrical safety IEC 335
Standard voltages DC (=): 24V
 (Other voltages and 60 Hz on request) AC (~): 24V - 115V - 230V / 50 Hz

coil type	power ratings				ambient temperature range (TS) (°C)	protection
	inrush ~ (VA)	holding		hot/cold =		
		(VA)	(W)	(W)		
CM12-FT	110	23,6	15,4	12 / 16,8	-20 to +75	moulded IP65

SPECIFICATIONS

pipe size	orifice size	flow coefficient Kv		operating pressure differential (bar)					coil type	catalogue number	OPTIONAL			
				min.	maximum (PS)									
					air (*)	water/oil (*)								
Rp	(mm)	(m ³ /h)	(l/min)		~	=	~	=	~/=		FPM	EPDM	CR	PTFE
3/4	19	5,7	95	0,35	17	17	14	14	CM12-FT	SC E210C013	V	E	J	
1	25	11,1	185	0,35	9	9	9	9	CM12-FT	SC E210D014	V	E	J	
1 1/4	28	12,8	213	0,35	9	9	9	9	CM12-FT	SC E210D018	V	E	J	
1 1/2	32	19,3	321	0,35	9	9	9	9	CM12-FT	SC E210D032	V	E	J	
2	44	37,0	617	0,35	9	9	9	9	CM12-FT	SC E210.103 (1)	V	E	J	T

(1) Floating piston construction

 The codes in the grey shaded areas correspond to commonly used products which can be supplied rapidly

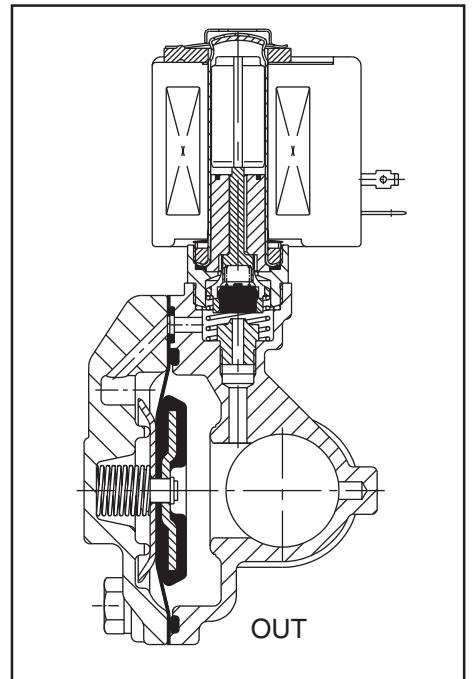

OPTIONS

- Valves can also be supplied with FPM (fluorelastomer / viton), EPDM (ethylene-propylene), CR (chloroprene / neoprene) and PTFE (teflon) sealings and discs. Use the appropriate optional suffix letter for identification
- Waterproof enclosure with embedded screw terminal coil and Pg 13,5 cable gland to meet CEE 10 (IP67)
- Explosionproof enclosures for hazardous locations according to "CENELEC" and national standards (see section 10)
- Explosionproof and watertight enclosures according to "NEMA" standards (see section 10)
- Compliance with "UL" and "CSA" standards
- Mounting brackets for the SC E210C013 only
- Plug with visual indication and with peak voltage suppression or with cable length of 2m (see section 11)

INSTALLATION

- The valves can be mounted in any position without affecting operation
- Pipe connection identifier is: E = Rp (ISO 7/1)
- The third digit in the catalogue number indicates the standard pipe connection
- Other pipe connections are available on request
- Installation/maintenance instructions are included with each valve
- Spare Parts Kit and replacement coils are available (see section 11)

DIMENSIONS (mm), WEIGHT (kg)

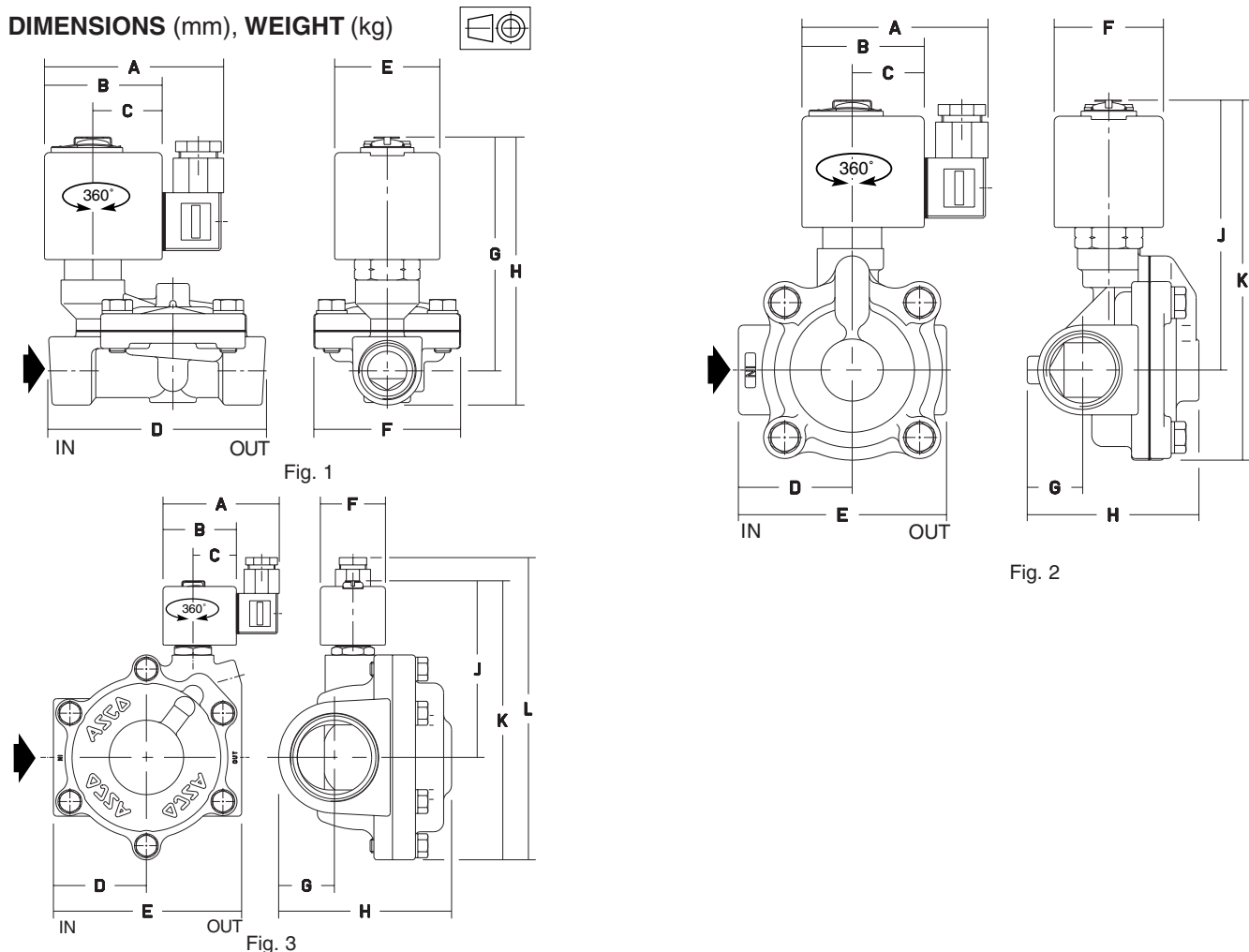

catalogue number SC E210	A	B	C	D	E	F	G	H	J	K	L	weight (1)	(C)
C013	86	56	33	96	50	70	112	138	-	-	-	1,6	Fig. 1
D014	86	56	33	52	95	50	25	75	125	165	-	2,0	Fig. 2
D018	86	56	33	52	95	50	30	85	125	165	-	2,0	Fig. 2
D032	86	56	33	56	111	50	33	95	128	178	-	2,5	Fig. 2
.103	86	56	33	65	129	50	38	119	138	208	208	4,6	Fig. 3

(1) incl. coil and connector

(C) construction type

All leaflets are available on: www.ascojoucomatic.com